

FLUSH STRAP HINGE

316 STAINLESS STEEL



Import



Precision
Cast



Suncor
Exclusive

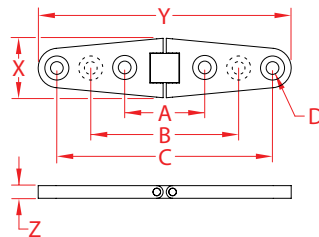

| ITEM | A | B | C | D | X (height) | Y (length) | Z (width) | WT (lb) | PACKAGING TYPE | EACH (qty) | INNER (qty) | CARTON (qty) | UPC |
|-------------------|-------|-------|-------|-------|---------------|---------------|--------------|------------|-------------------|---------------|----------------|-----------------|--------------|
| HEAVY DUTY | | | | | | | | | | | | | |
| S3831-0001 | 1.40" | N/A | 3.40" | 0.20" | 0.90" | 3.95" | 0.20" | 0.14 | POLYBAG | 1 | 5 | 225 | 791506058199 |
| S3831-0002 | 1.20" | 3.18" | 5.15" | 0.20" | 0.97" | 6.00" | 0.20" | 0.23 | POLYBAG | 1 | 1 | 100 | 791506058205 |

NOTE:

USE 4 #10 FASTENERS. EXCLUSIVE FLUSH DESIGN CAN MOVE 360 DEGREES. ONE HALF FOLDS FLAT ON TOP OF OTHER HALF. IDEAL FOR TABLES, DOORS AND OTHER APPLICATIONS WHERE RECESSED HINGES ALLOW A TOTALLY FLAT SURFACE.

REFERENCE "FASTENER MATCHING CHART" FOR COMPATIBLE FASTENERS.

ALL DIMENSIONS ARE NOMINAL (+/- 3%) AND ARE SUBJECT TO CHANGE WITHOUT NOTICE.